



Part number

5C6 052 186
5C1 052 186USA: Distributed by
Volkswagen of America, Inc.
Auburn Hills / Mi.

Equipment supplied is subject to alteration

Printed in Germany
by Volkswagen Zubehör GmbH

Vehicles:

VW Jetta
VW Beetle**09/10 >>****09/11 >>****USA****Safety regulations and precautions → see page two****WARNING !**

This fog light kit should be used only in vehicles with halogen head lamps, and must not be used in vehicles with gas-discharge (Xenon) head lights. Otherwise, the vehicle's electronics will be damaged seriously!

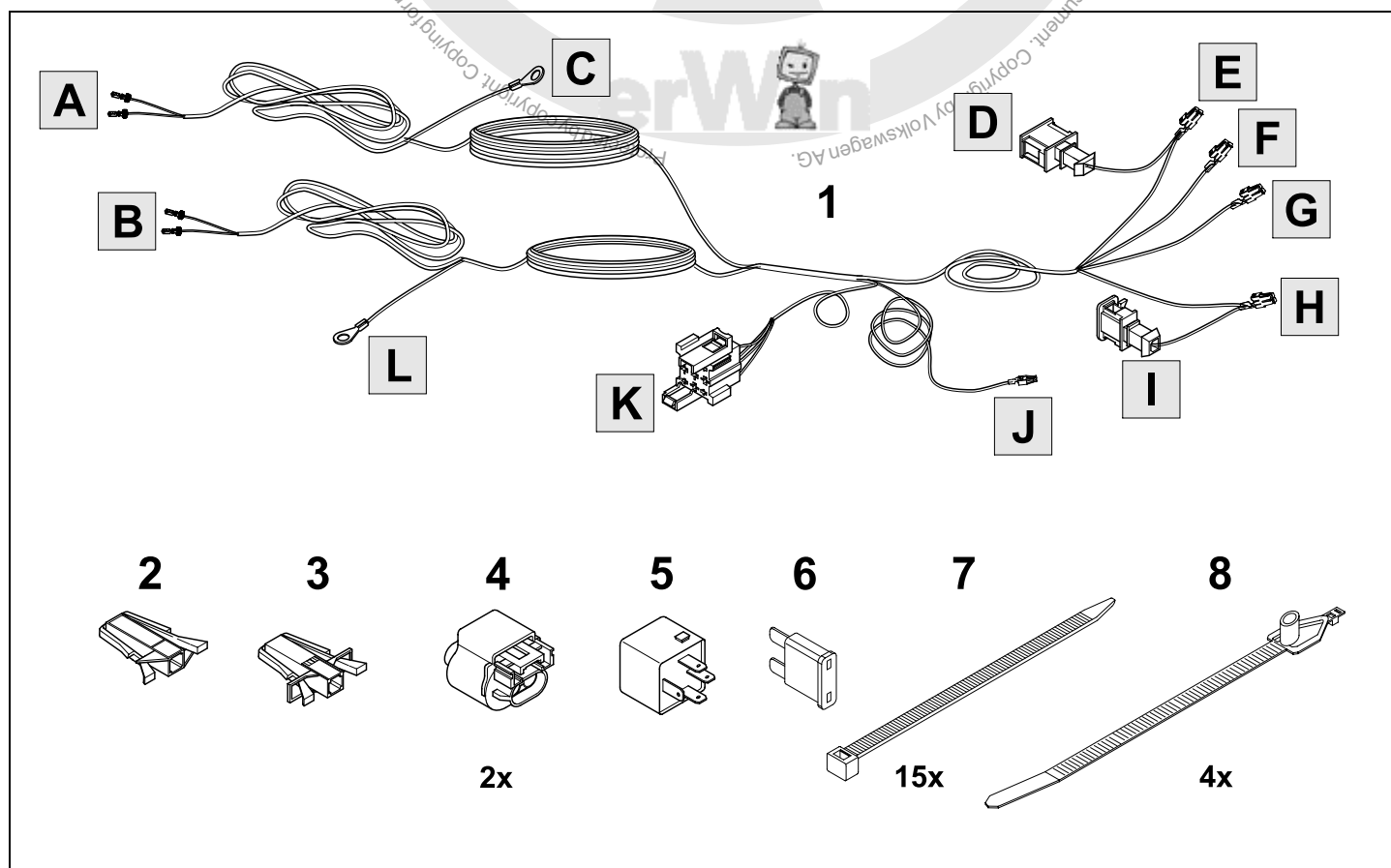
Content / Parts contained in this kit



WARNING !

Installation procedures

- Read entire instructions thoroughly before starting work
- Improper installation procedures can cause serious personal injury
- Installation should be performed by a qualified technician only
- Keep unqualified persons and children away from the vehicle while working on the vehicle
- Observe all safety precautions when working under a vehicle
- Beware of sharp edges
- Always wear safety glasses to protect eyes
- Always wear protective gear as gloves and use caution when using hand tools

Work tidy and clean

- Before starting make sure painted and trim surfaces are protected to avoid scratching during installation process of the items
- Use proper surface protection covers, work without attire and free of dirt and grease

Engine compartment

- Do not work on the vehicle while the engine is running
- The engine compartment of any motor vehicle is a potential dangerous area and can cause serious personal injury, hot vehicle components can cause serious burns
- When working in a hot area of the vehicle, always let components cool down before starting any work
- Always use extreme caution when doing any work in the engine compartment. Always follow commonly accepted safety practices and use common sense. Never risk personal injury
- Always let the engine cool down completely before carefully opening the engine compartment, hot components will burn skin on contact

Electrical system

- Working on the battery or the electrical system in any vehicle can result in serious acid burns, fires or electrical shocks. Always read and heed the following warnings and safety precautions before working on the battery or the electrical system:
- Before working on the electrical system, always switch off the ignition and all electrical consumers and disconnect the negative (-) earth cable from the battery first
- Always keep children away from acid and the battery
- Always wear eye protection. Never let battery acid or lead particles contact your eyes, skin and clothing
- Sulfuric acid is very corrosive and can cause blindness and damage to unprotected skin. Always wear protective gloves and eye protection. To reduce the risk of injury, never tilt the battery, as this could spill acid through the vents and may cause burns
- When disconnecting the battery from the electrical system, always disconnect the negative earth cable (-) first and then the positive cable (+)
- Always avoid fires, sparks, open flames and smoking. Always avoid generating sparks and electrostatic charges when handling cables and electrical equipment. Never short circuit the battery poles. High energy sparks can cause serious personal injury
- Always switch off all electrical consumers before reconnecting the battery. Reconnect the positive cable (+) first and then the negative earth cable (-). Never reverse the polarity of these connections. This will cause a fire or a battery explosion

TOOLS

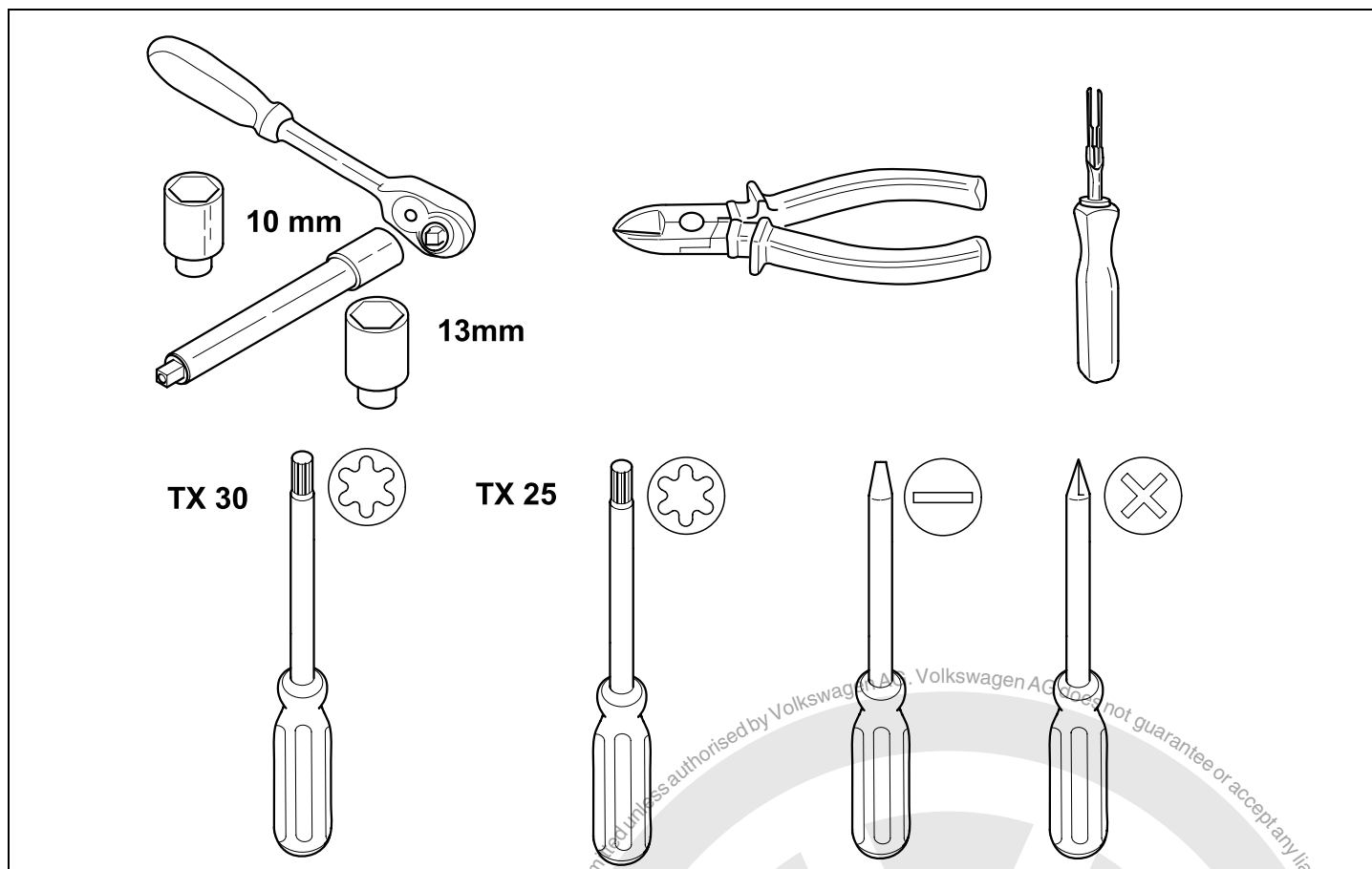

Additional parts required Jetta

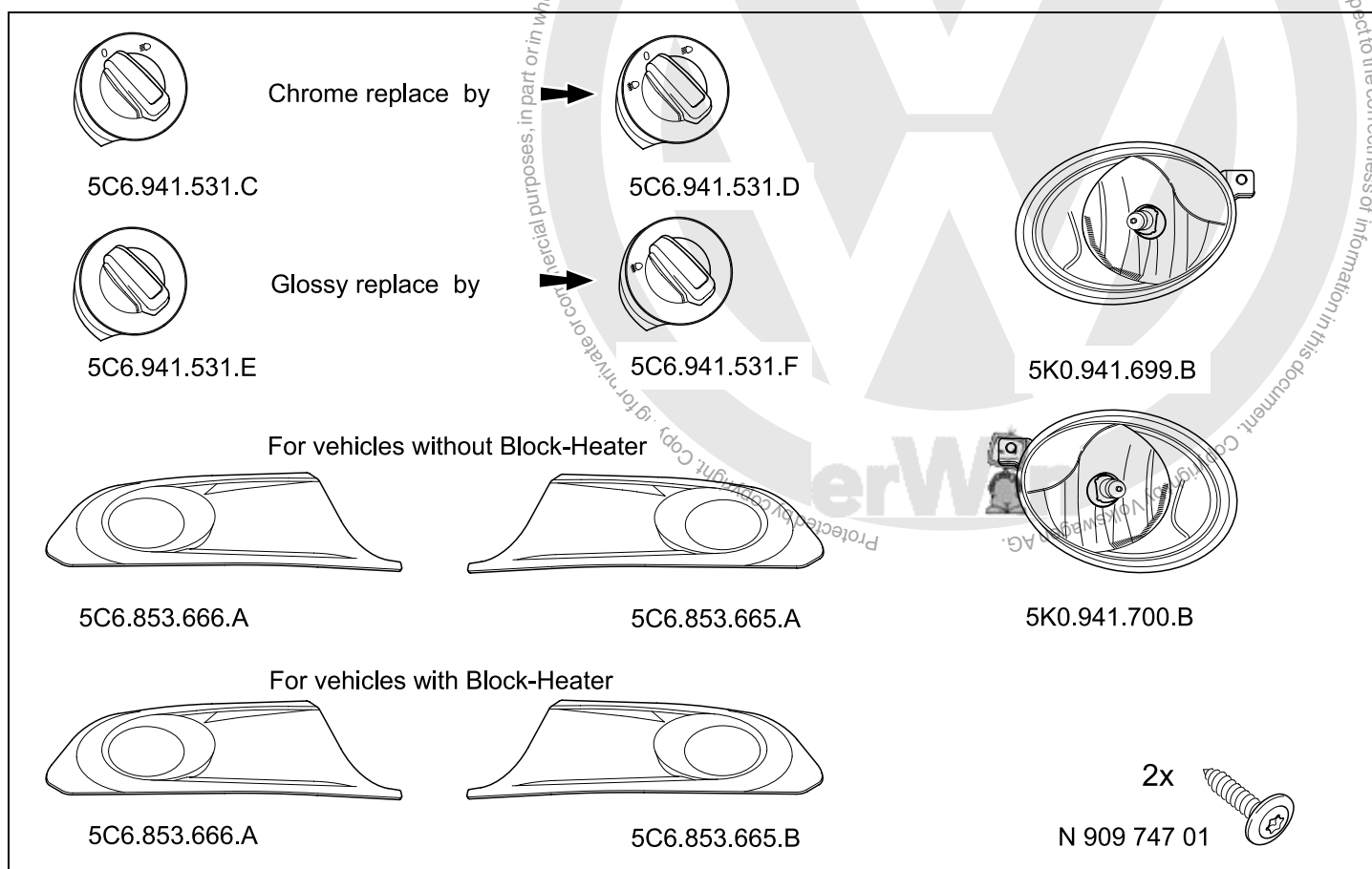

Additional parts required Beetle

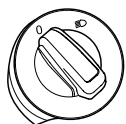

Chrome replace by

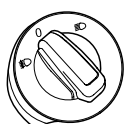

5C6.941.531.C

5C6.941.531.D

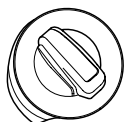

Glossy replace by

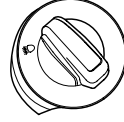

5C6.941.531.E

5C6.941.531.F

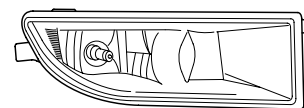

5C5.941.700

For vehicles without chrome cover parts

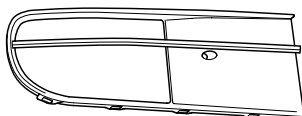

5C5.853.666.D

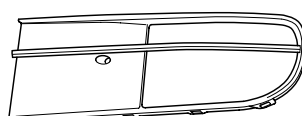

5C5.853.665.D



5C5.941.699

For vehicles with chrome cover parts

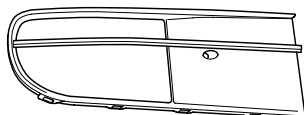

5C5.853.666.E



5C5.853.665.E

6x

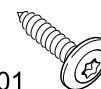

N 909 747 01



NOTE !

The parts which are depicted in the previous figures are not contained in this kit and must be obtained separately.

These are in detail:

- Rotary light switch
 - o For Jetta and Beetle 5C6.941.531.D respectively 5C6.941.531.F
- Cover parts
 - o For Jetta 5C6.853.666.A, 5C6853.665.A respectively 5C6.853.665.B
 - o For Beetle 5C5.853.666.D, 5C5.853.665.D respectively 5C5.853.666.E, 5C5.853.665.E
- Screws
 - o For Jetta and Beetle N.911.604.01
- Fog lamps
 - o For Jetta 5K0.941.700 and 5K0.941.700.B
 - o For Beetle 5C5.941.700 and 5C5.941.699

The existing rotary light switch should be replaced by the respective rotary light switch with the additional function "fog lights on" (refer to previous figure)

The chromed moldings (partnumbers 561.853.102, 561.853.101) should be removed carefully from the existing cover parts and clipped into the new ones

Before installing this kit the actuality of all work steps and all part numbers should be checked in ETKA and ELSA

1 Remove ignition key and disconnect battery earth cable

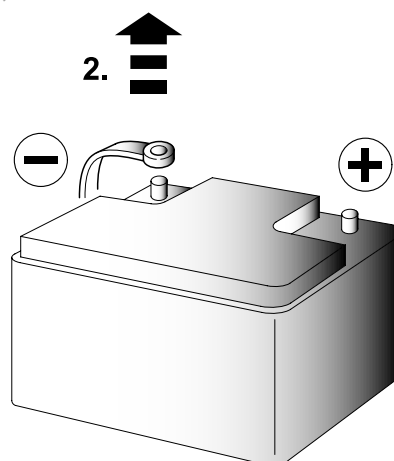
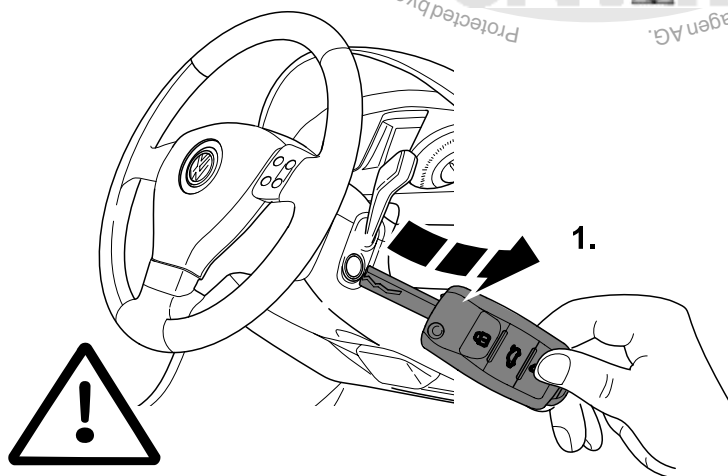

2 General installation overview

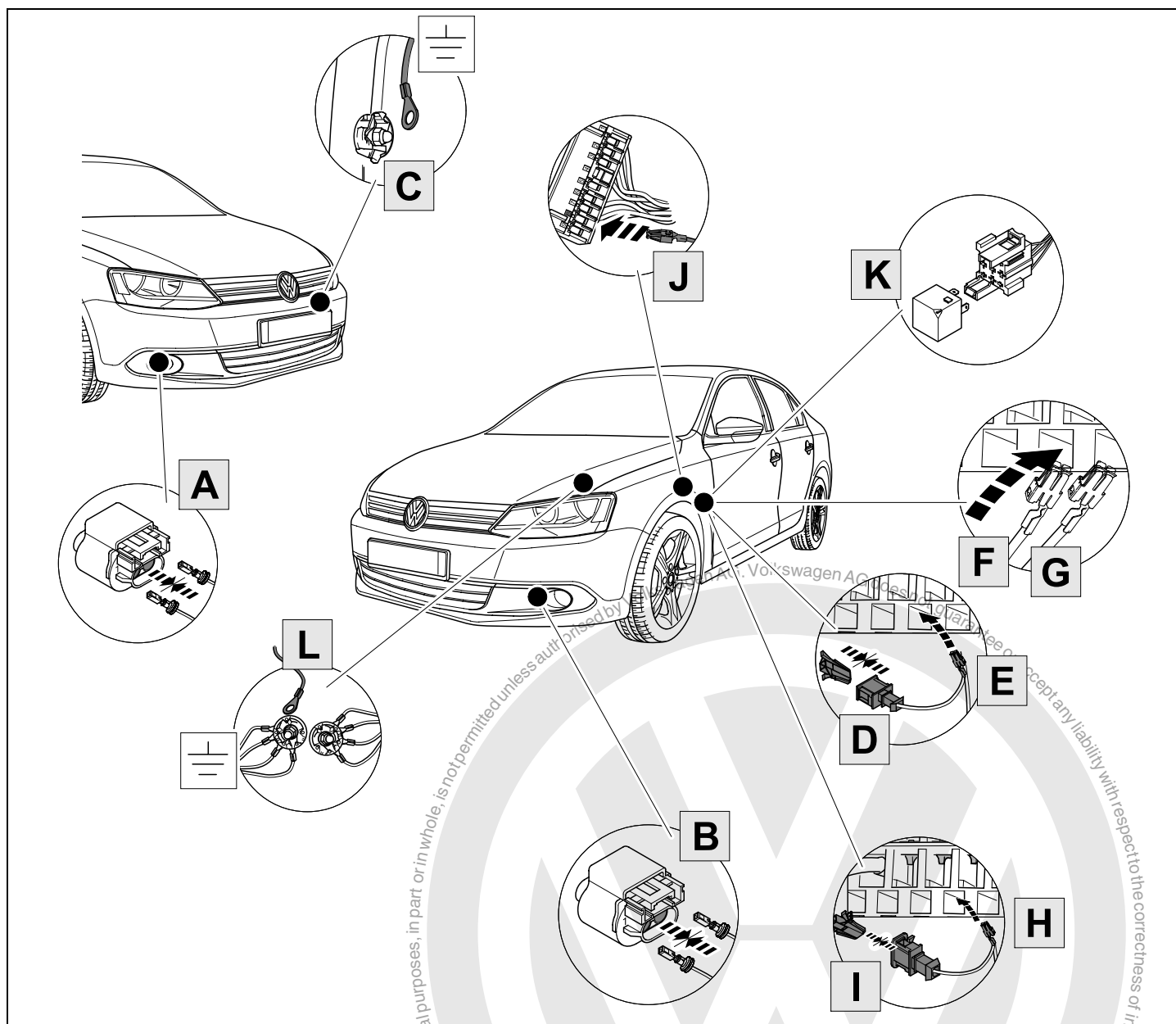

3 Interior parts to be removed **Jetta**

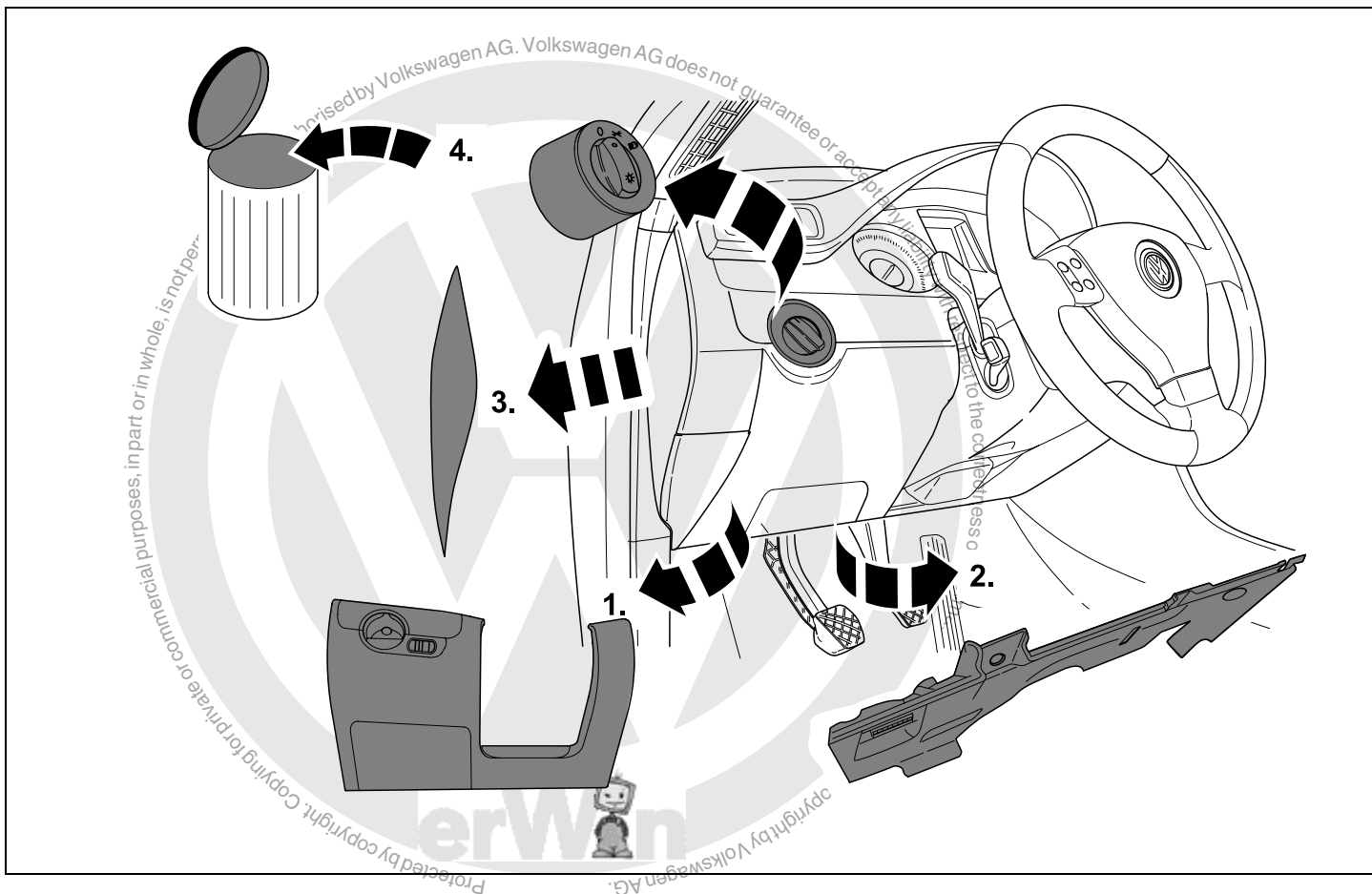

4 Interior parts to be removed **Beetle**

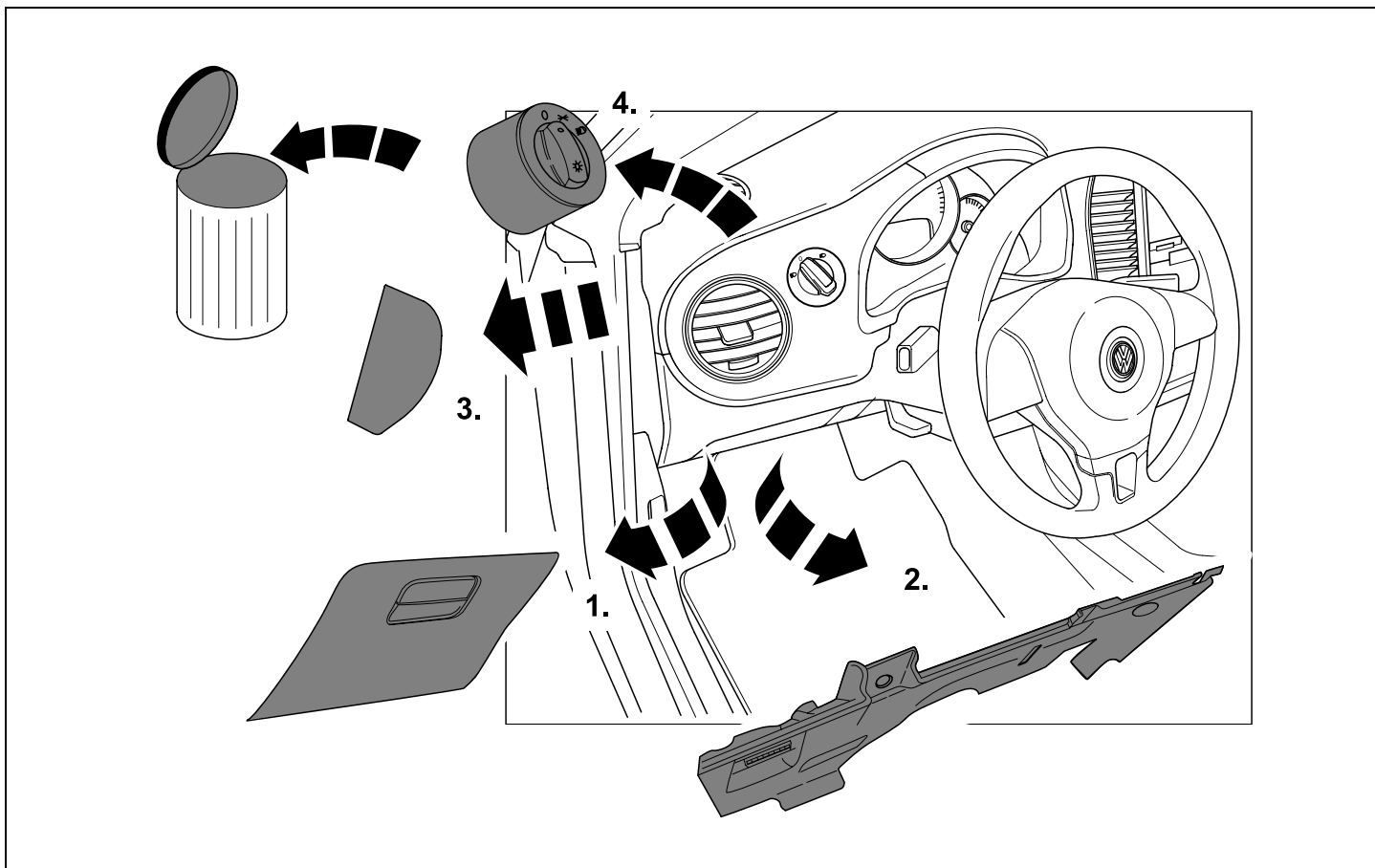

5 Removal of the fuse box Jetta / Beetle

Jetta

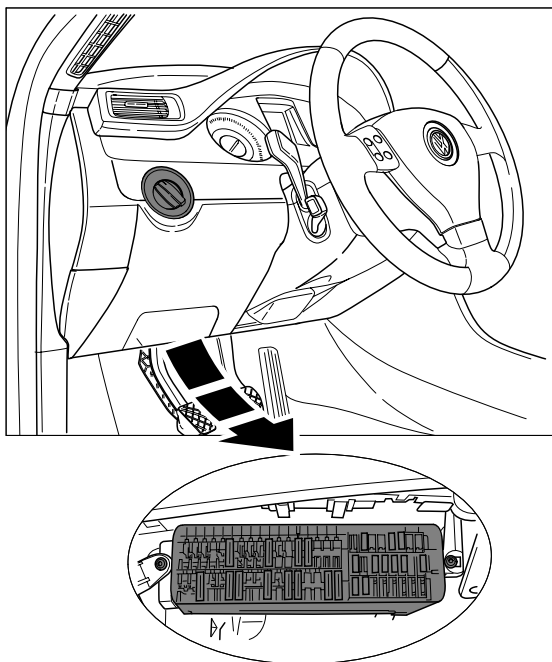

Beetle

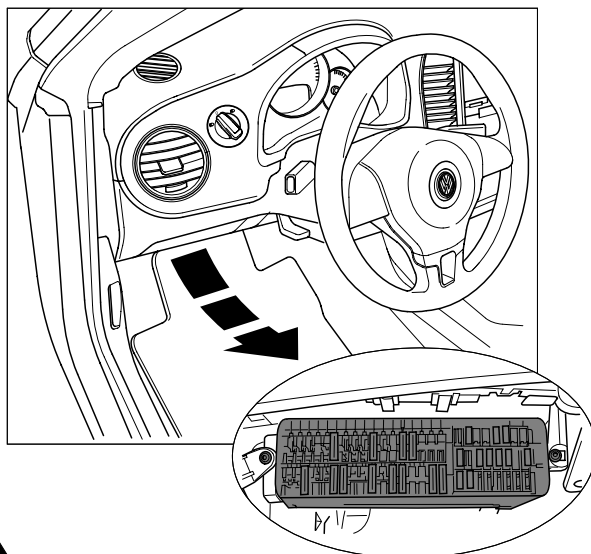

6 Engine compartment parts to be removed Jetta / Beetle

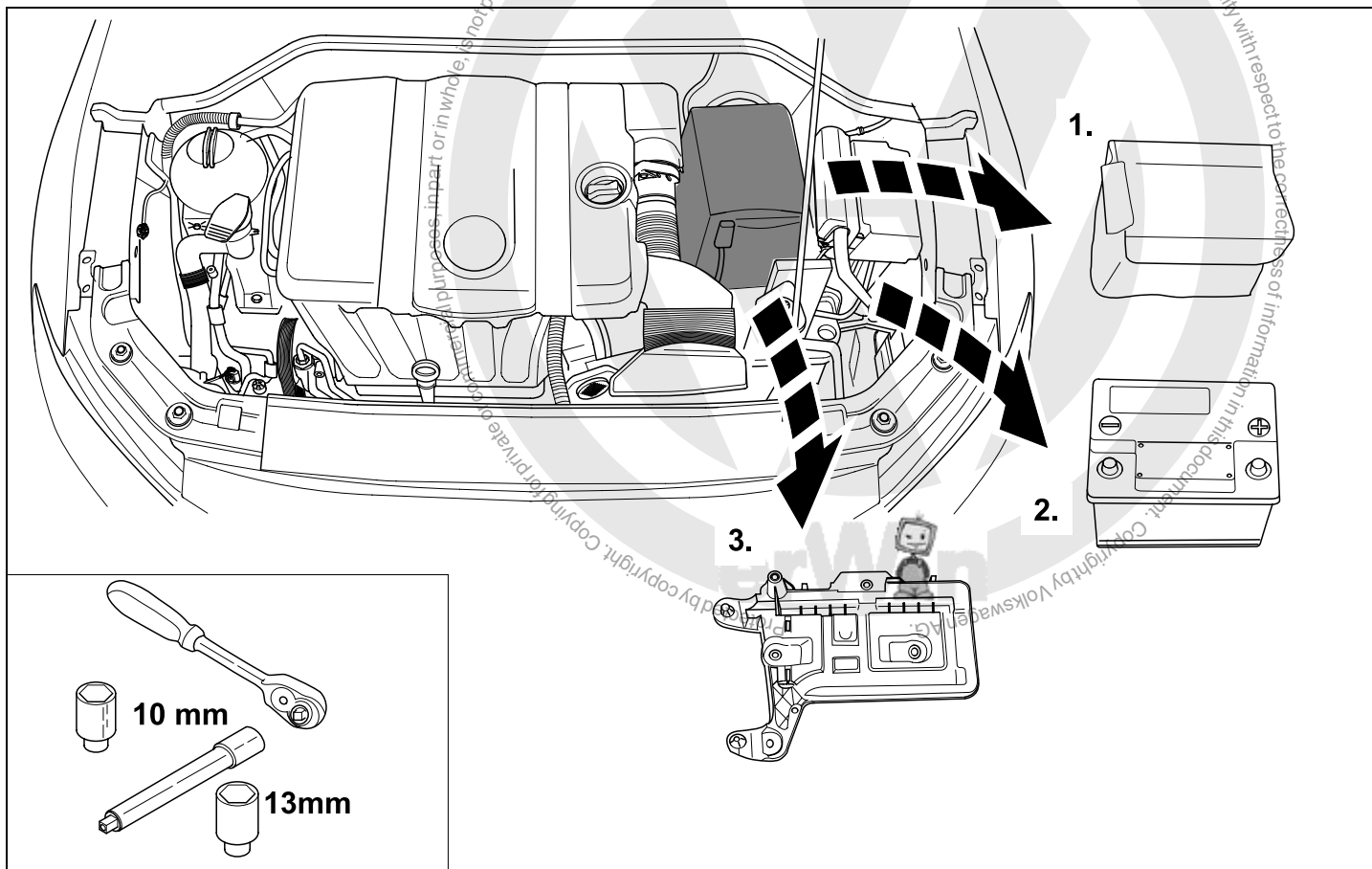

7 Remove cover parts **Jetta / Beetle**

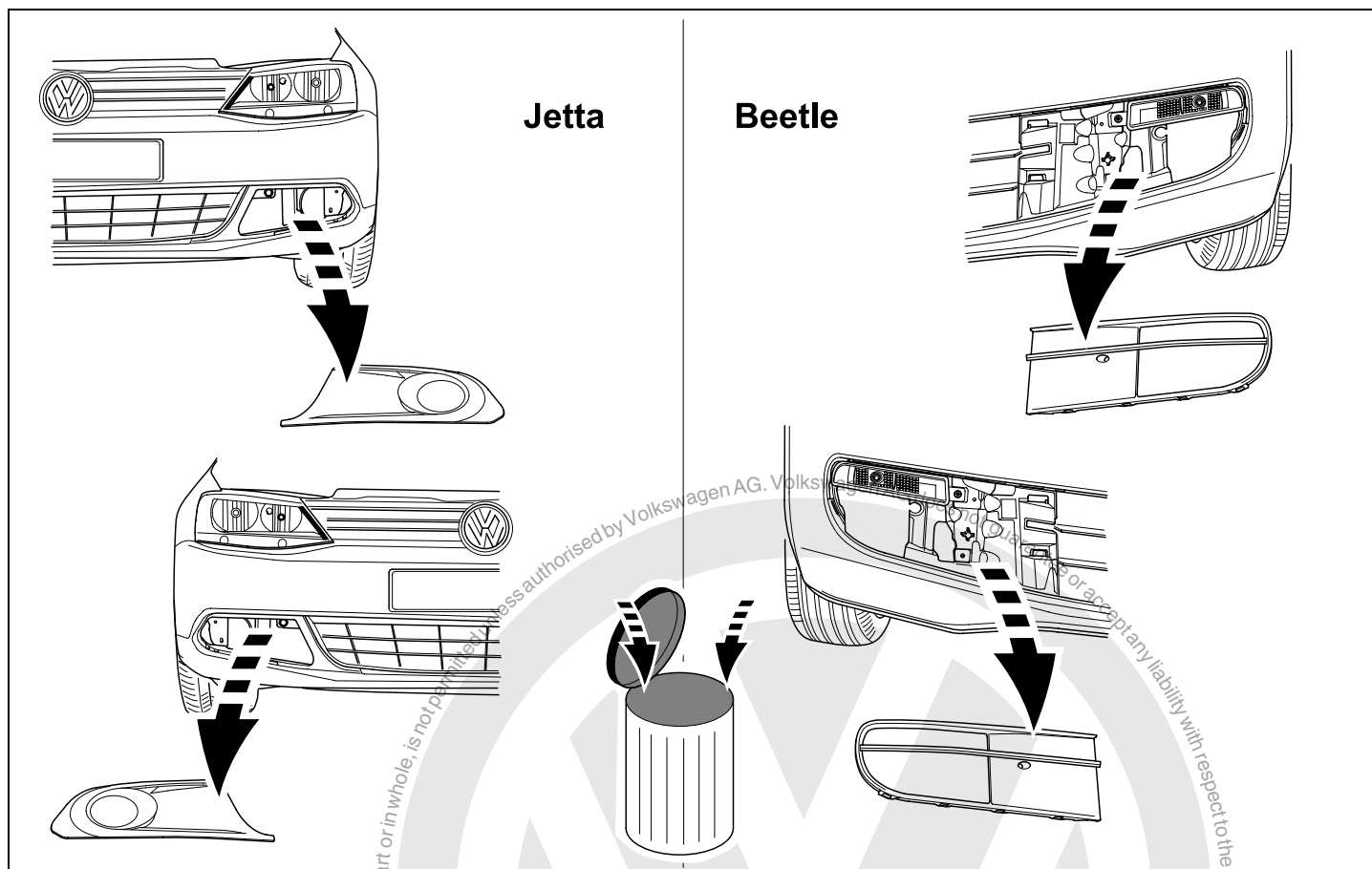

8 Installation overview inner compartment **Jetta / Beetle**

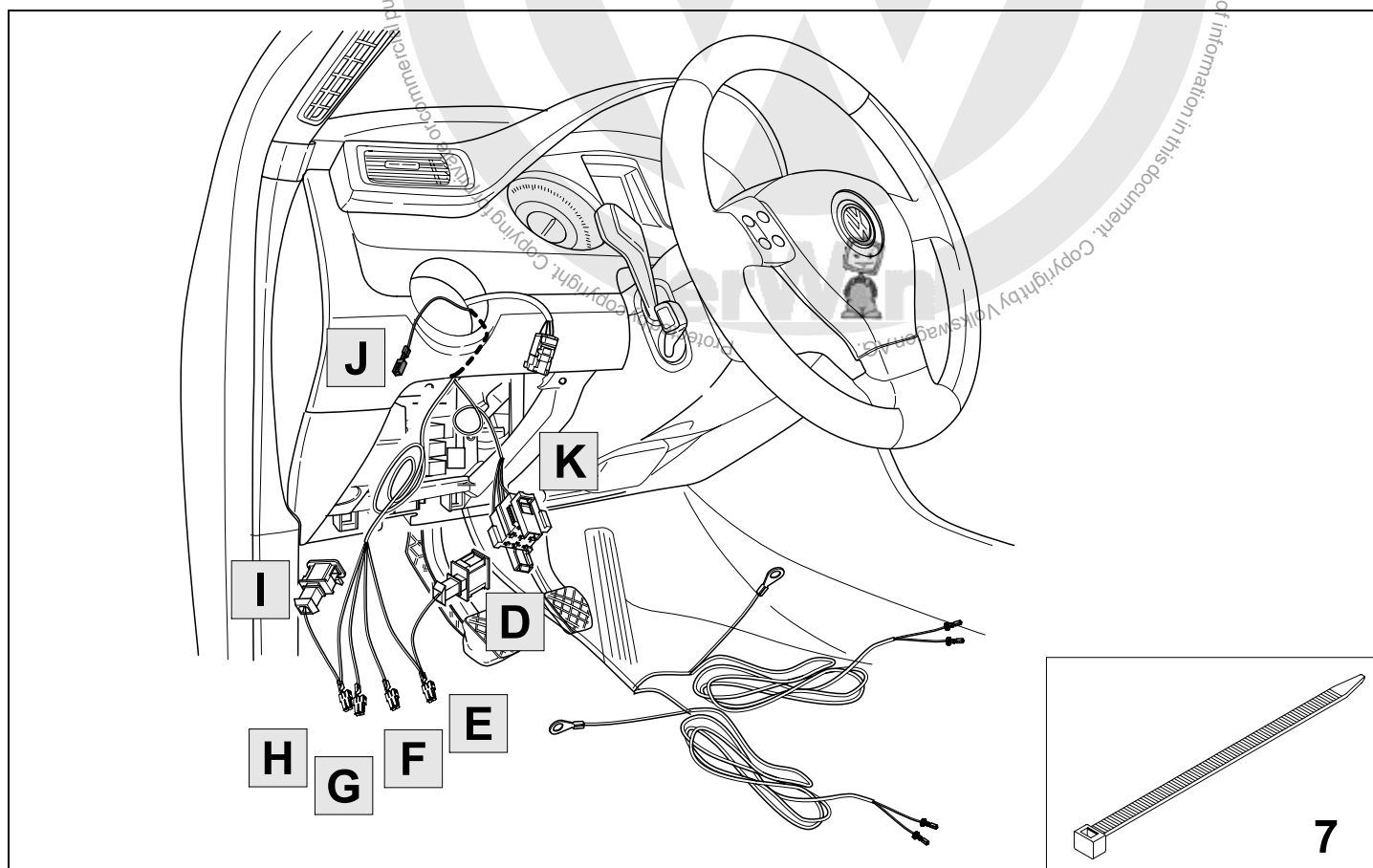

9 Connect and fix relay Jetta / Beetle

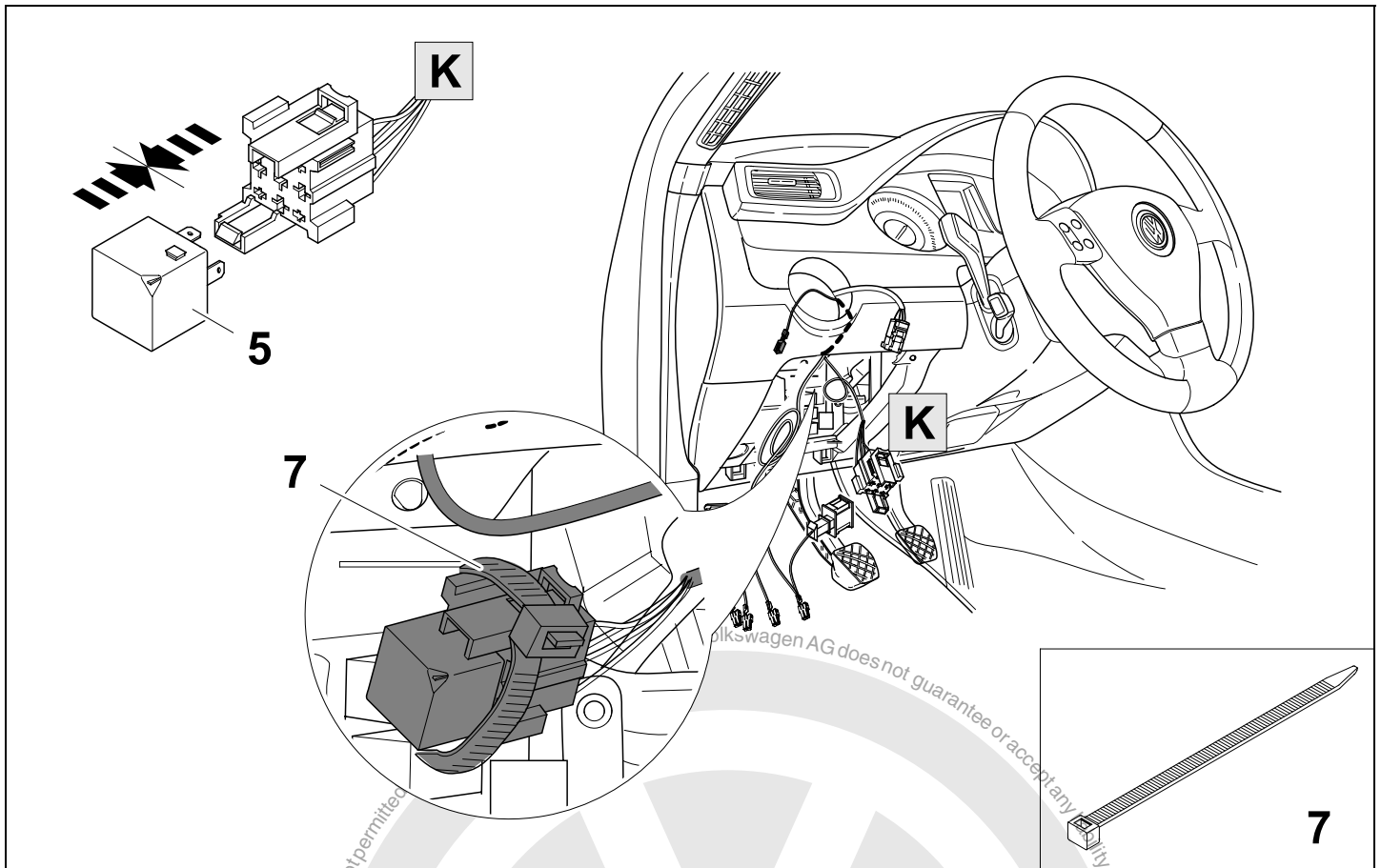

10 Contact to light switch connector Jetta / Beetle

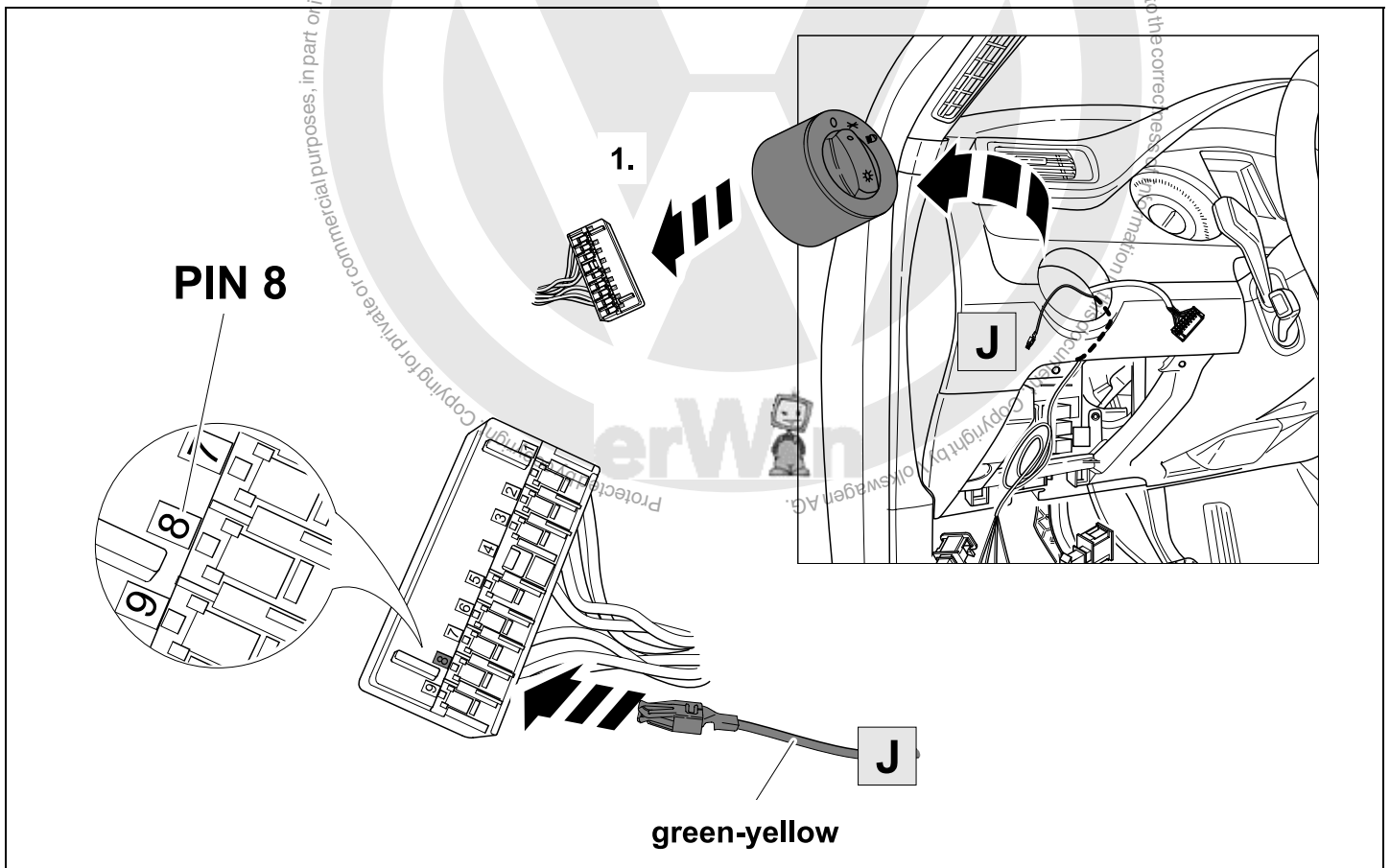

11 Fuse box adaption high beam signal Jetta / Beetle

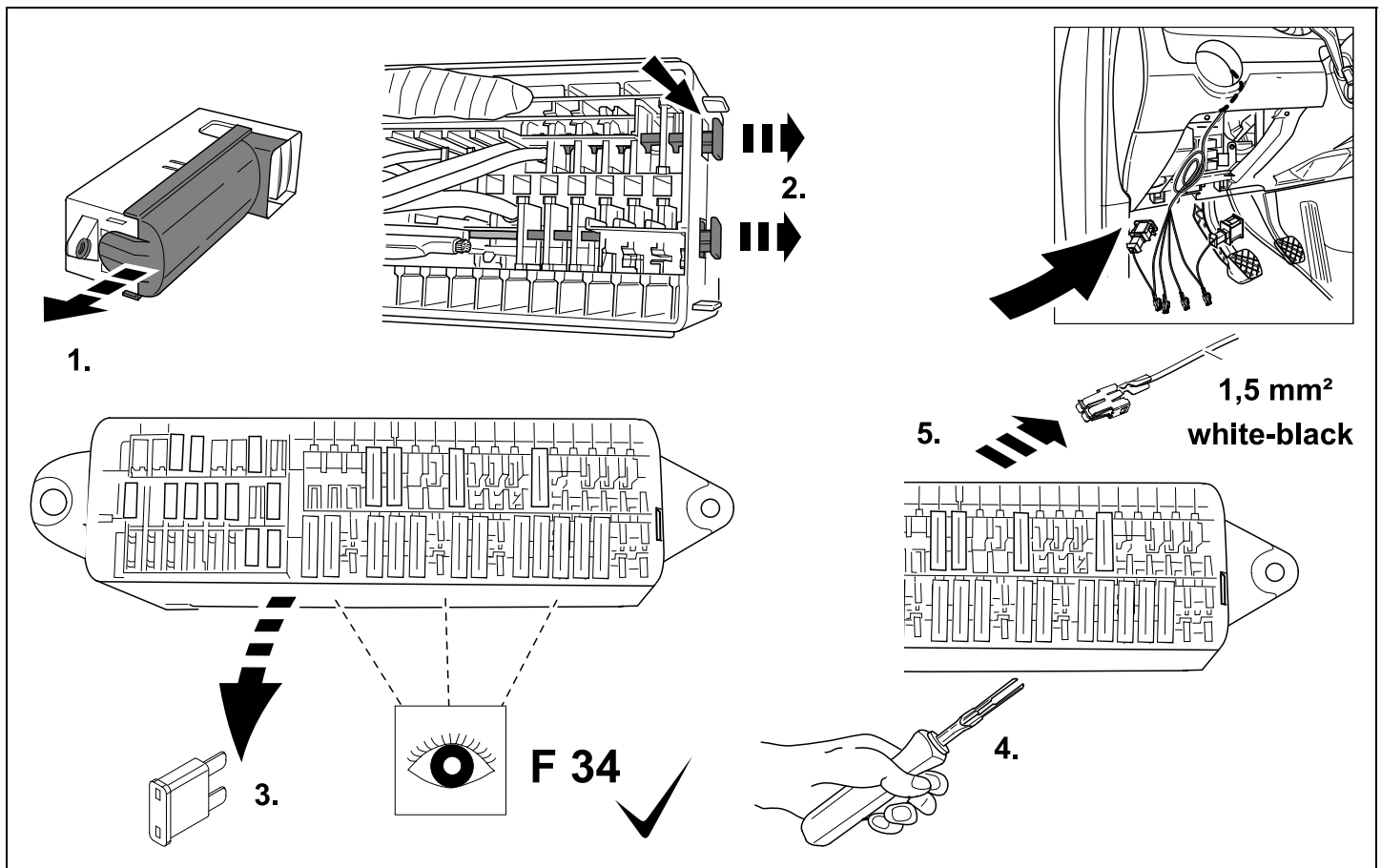

12 Fuse box adaption high beam signal Jetta / Beetle

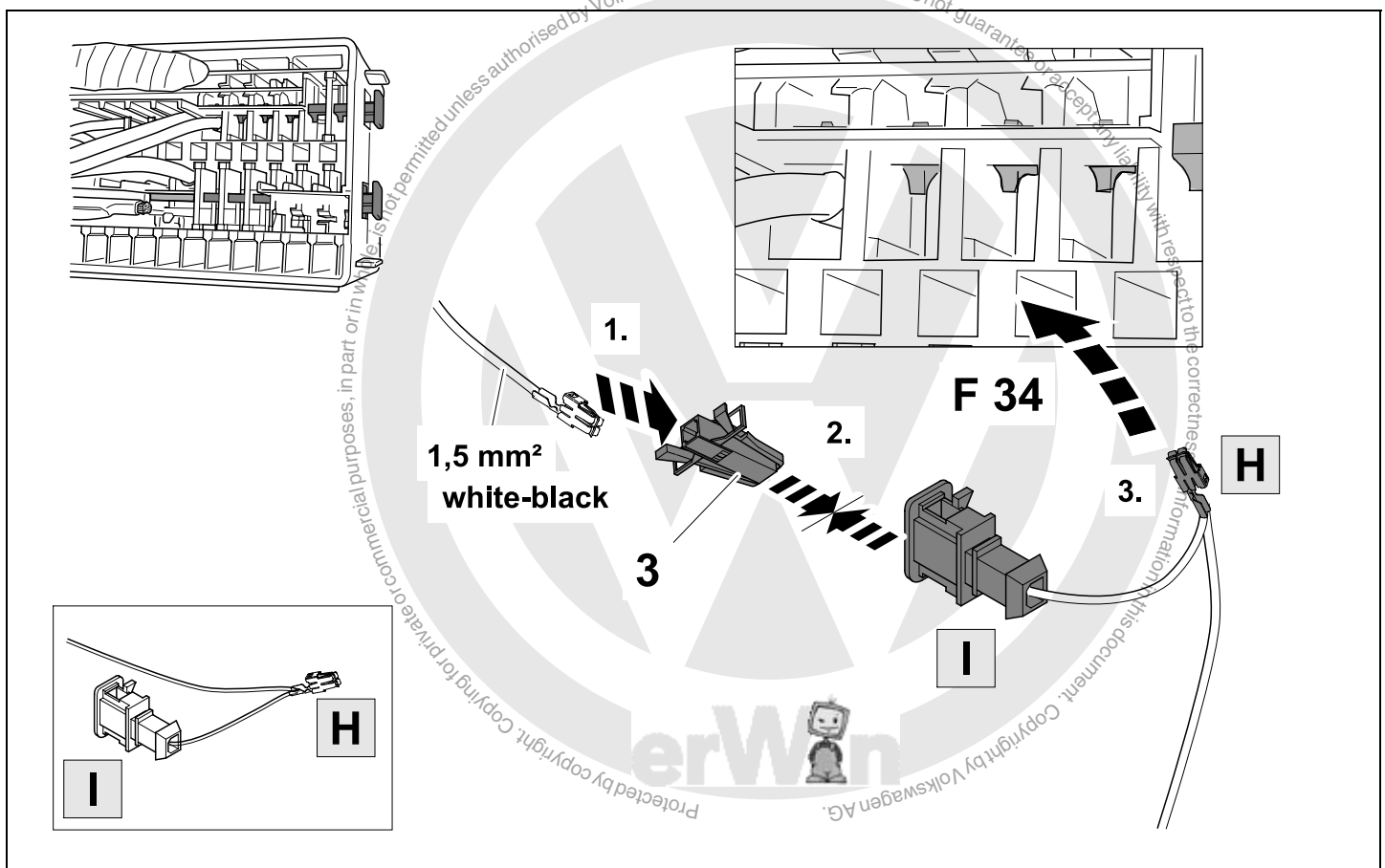

13 | Fuse box adaption park light signal **Jetta / Beetle**

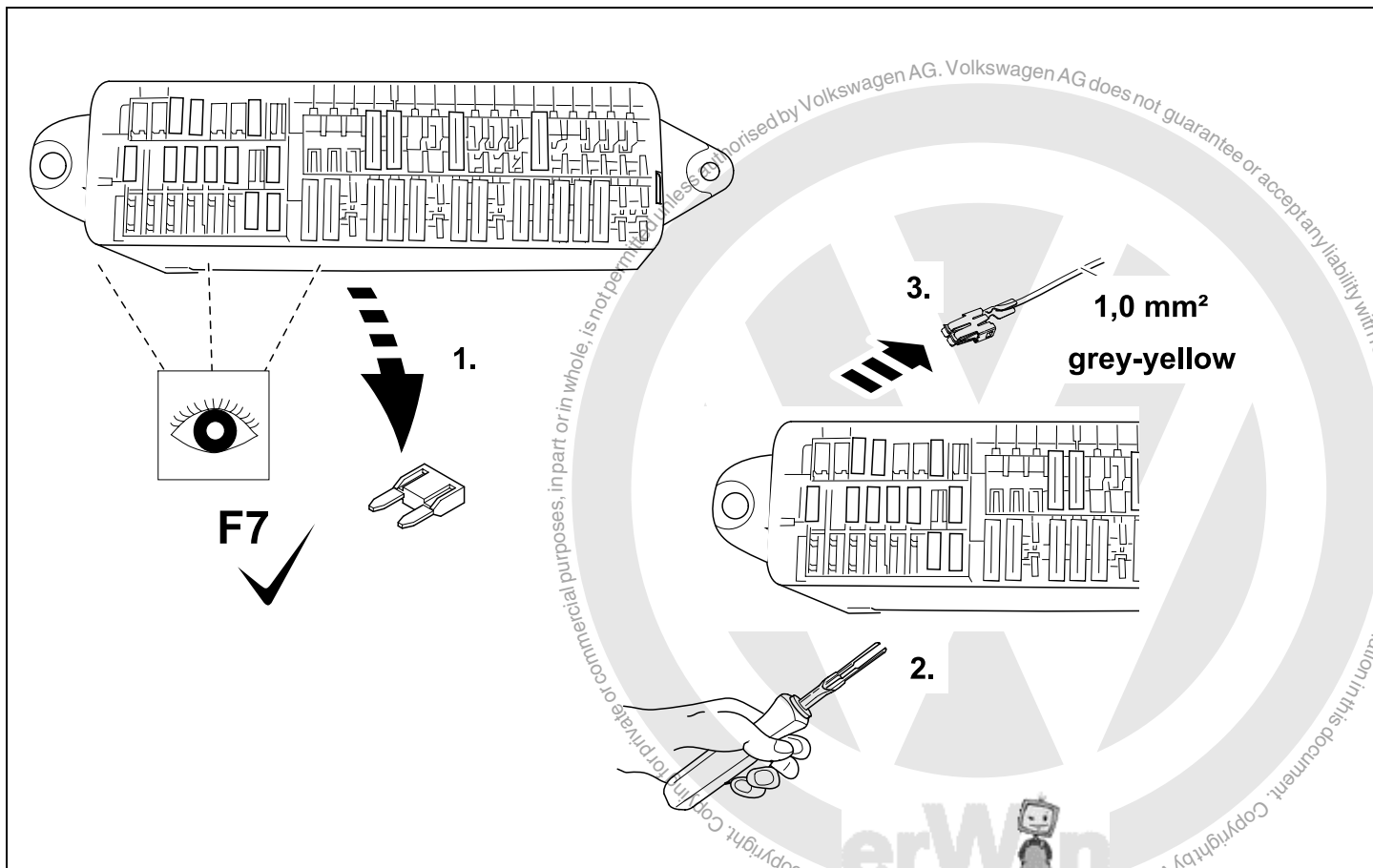

14 Fuse box adaption park light signal Jetta / Beetle

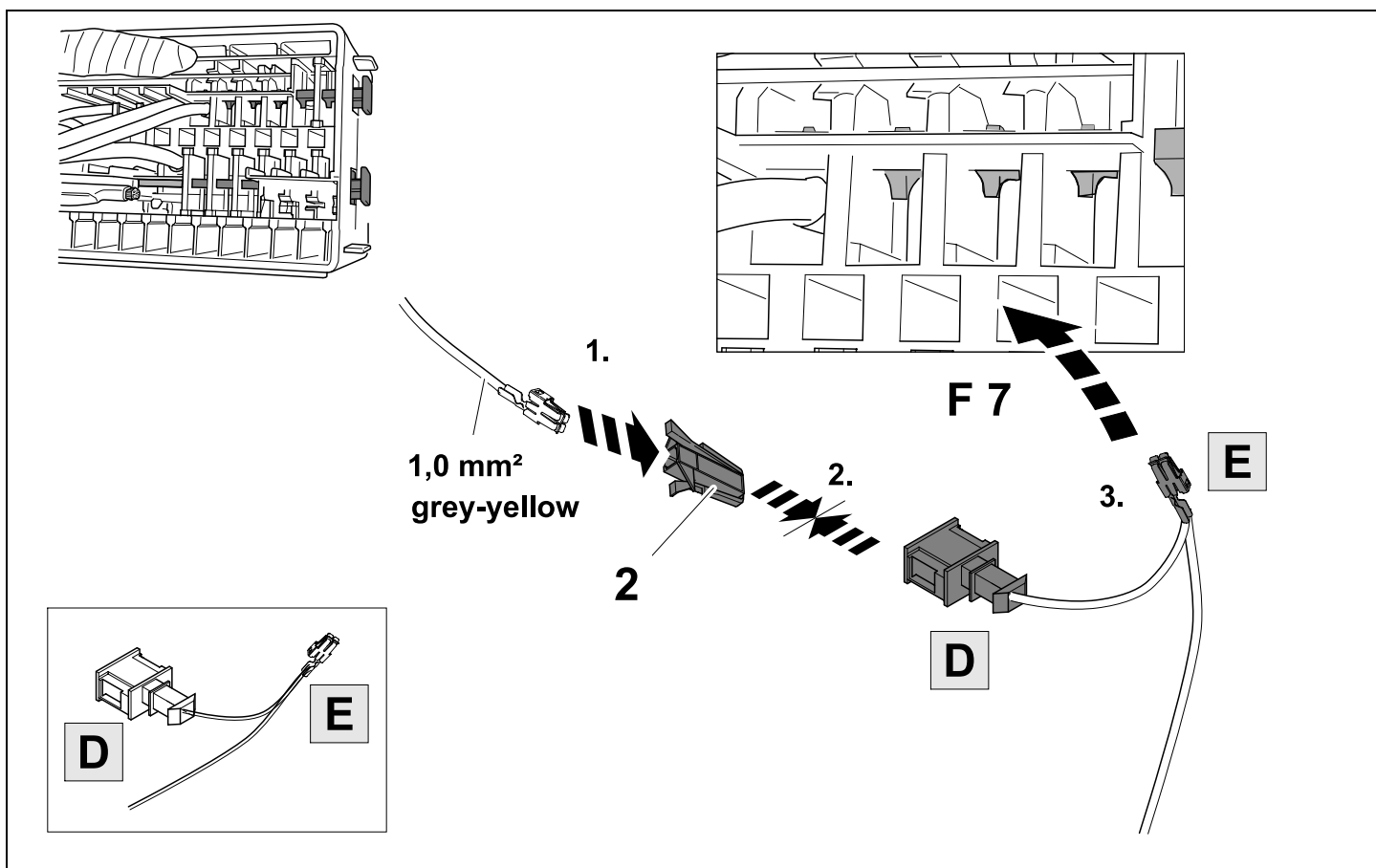

15 Fuse box adaption fog light fuse Jetta / Beetle

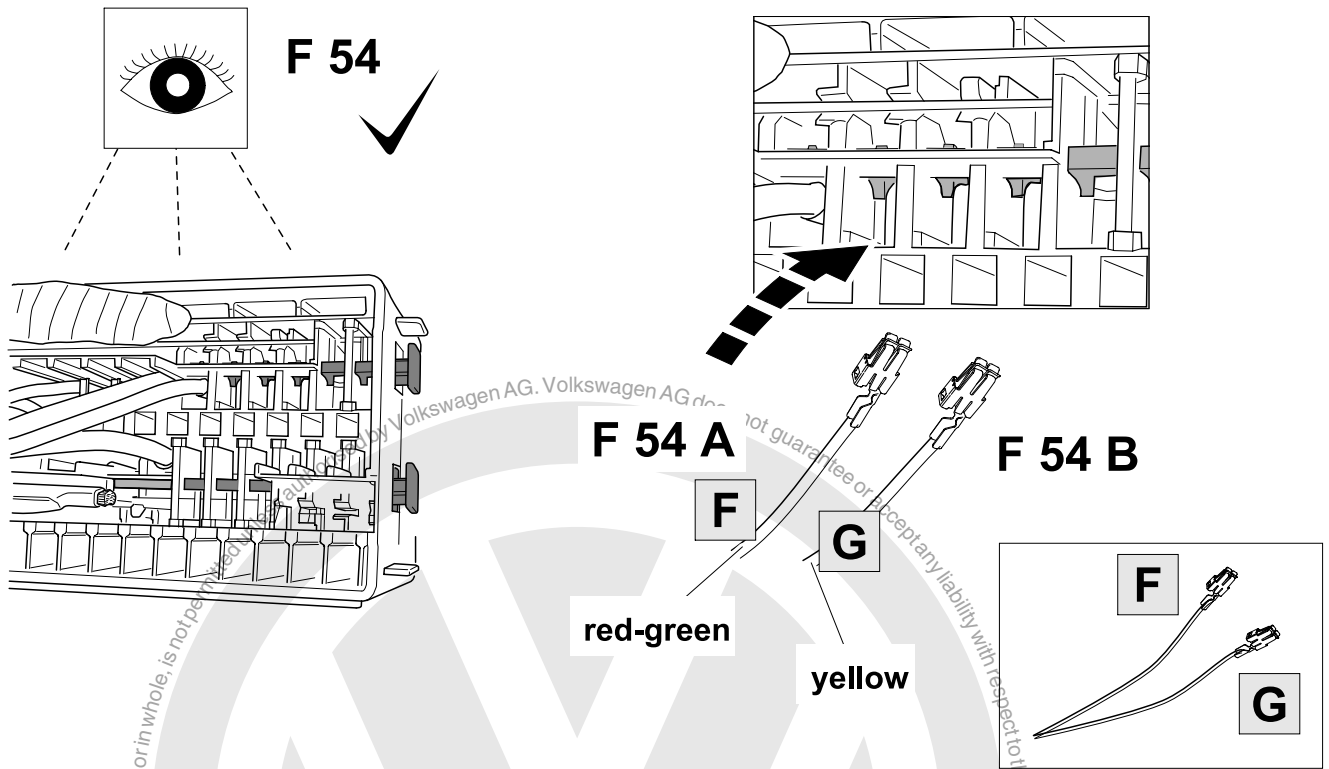

16 Fuse box adaption Jetta / Beetle

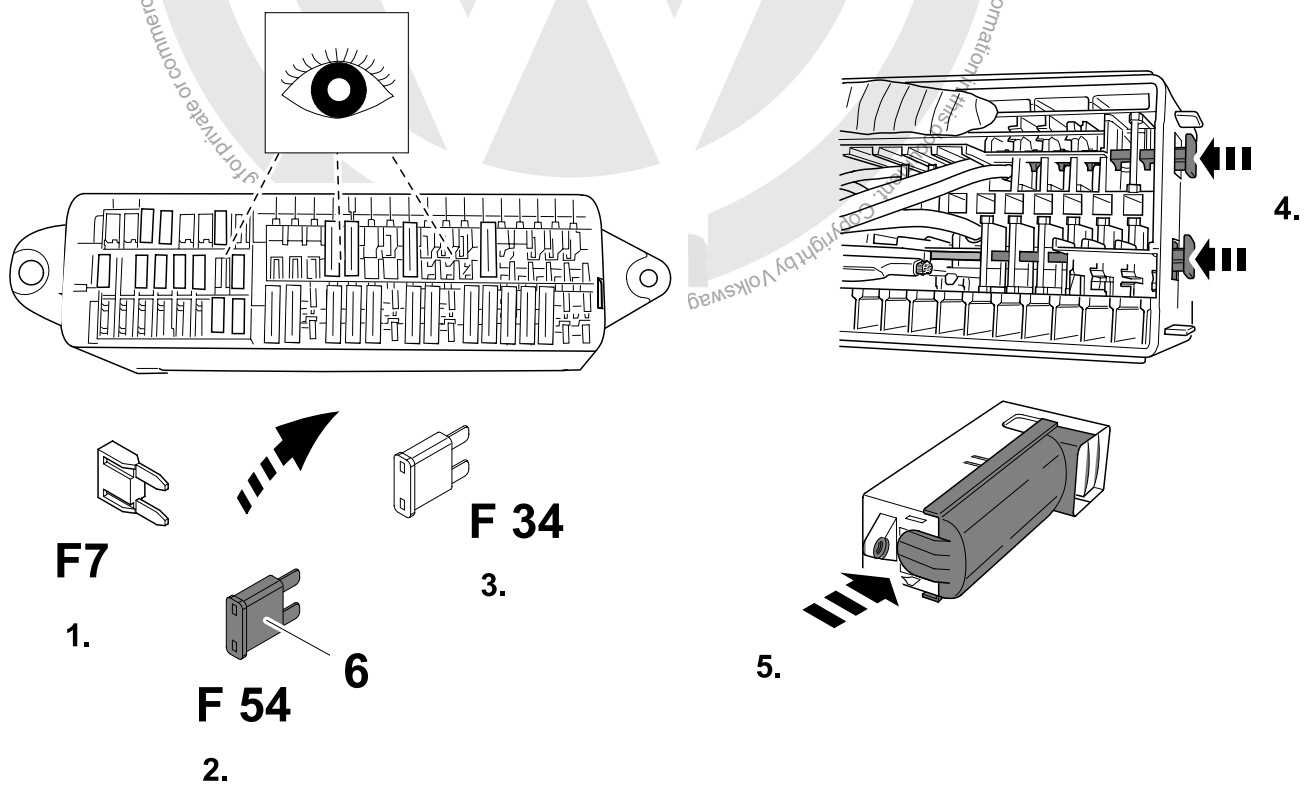

17 Break-through to engine compartment **Jetta / Beetle**

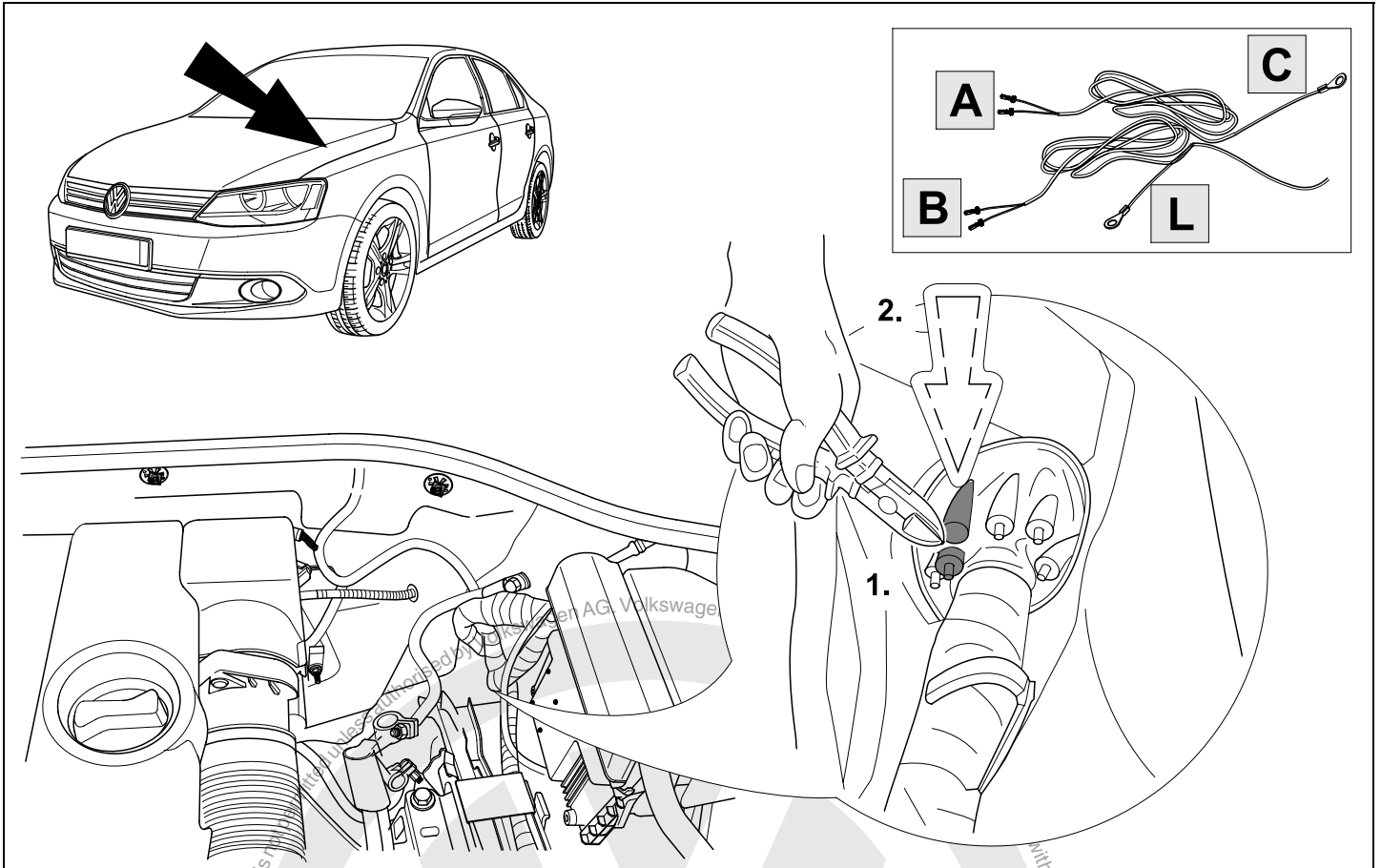

18 Wire routing engine compartment Jetta / Beetle

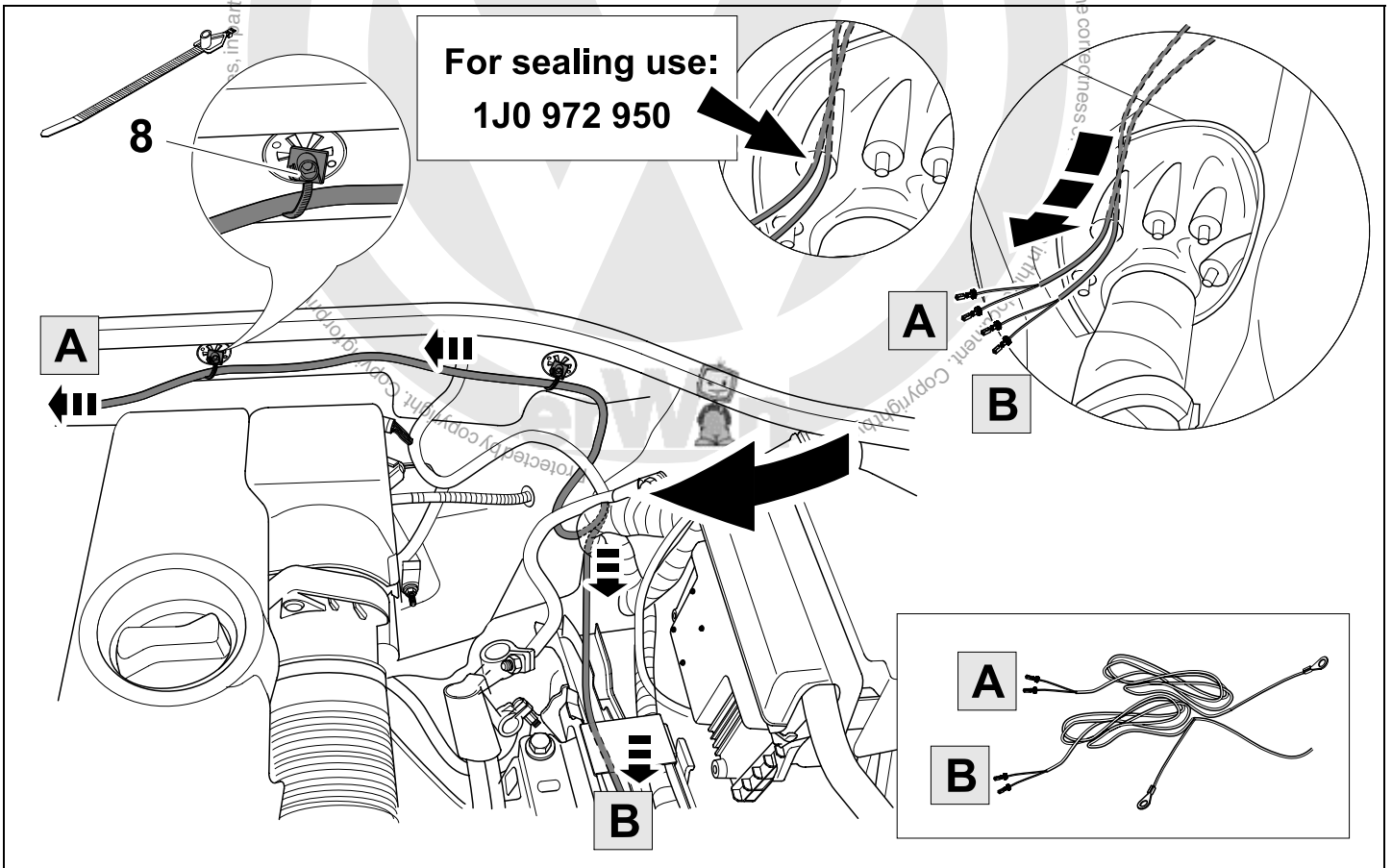

19 Wire routing engine compartment Jetta / Beetle

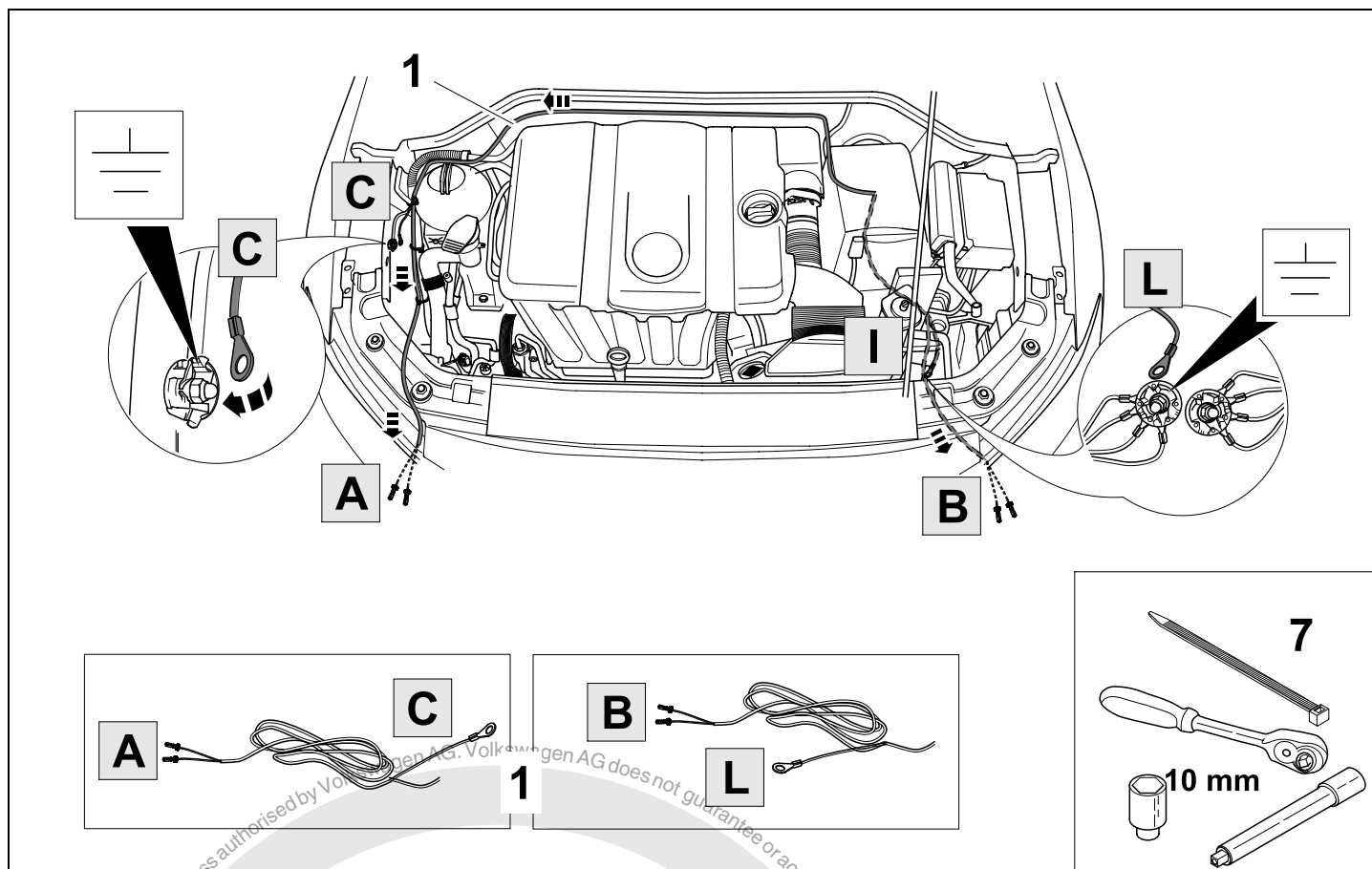

20 Connect fog lamp plugs Jetta / Beetle

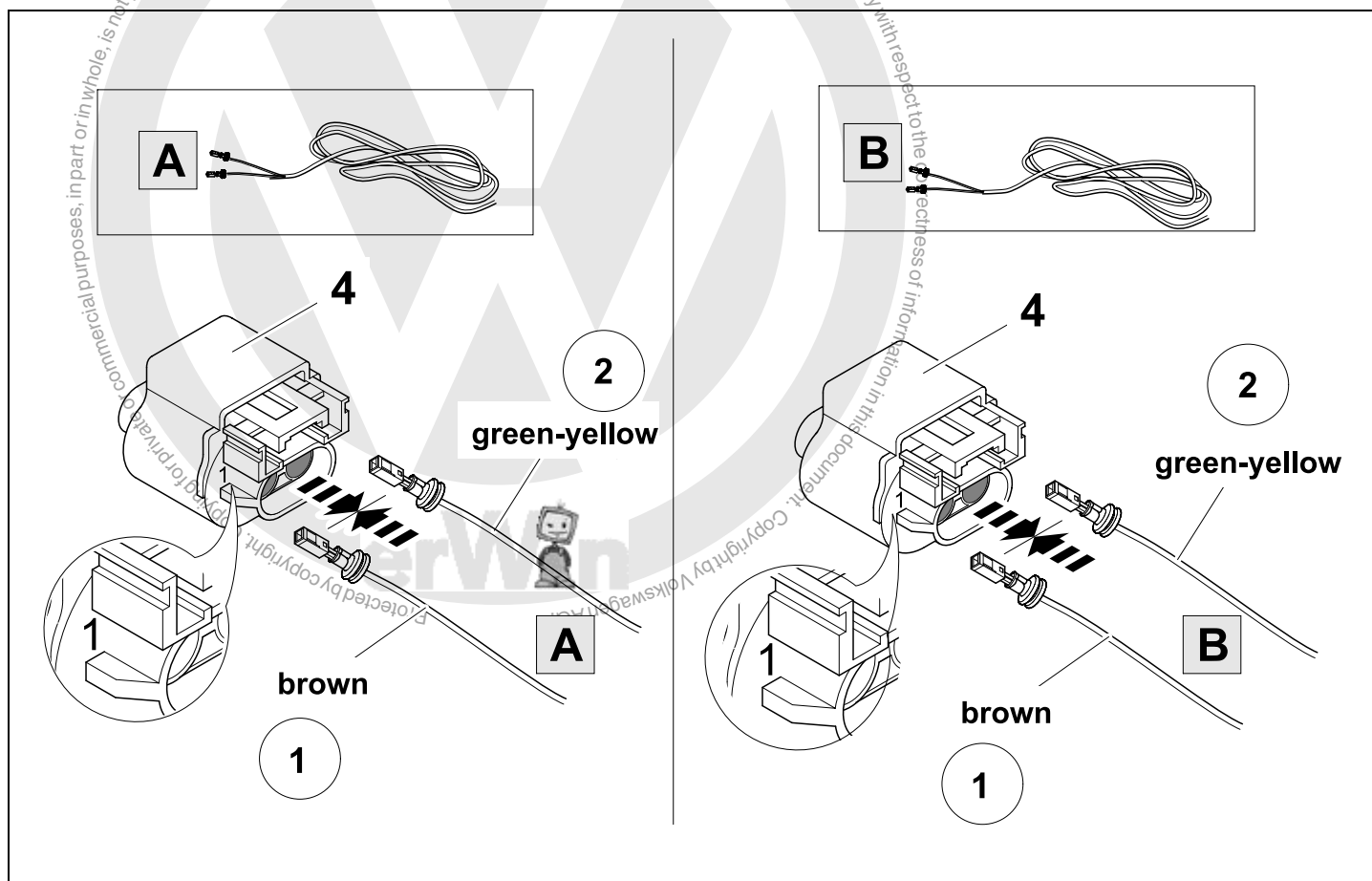

21 Fog lamp installation Jetta

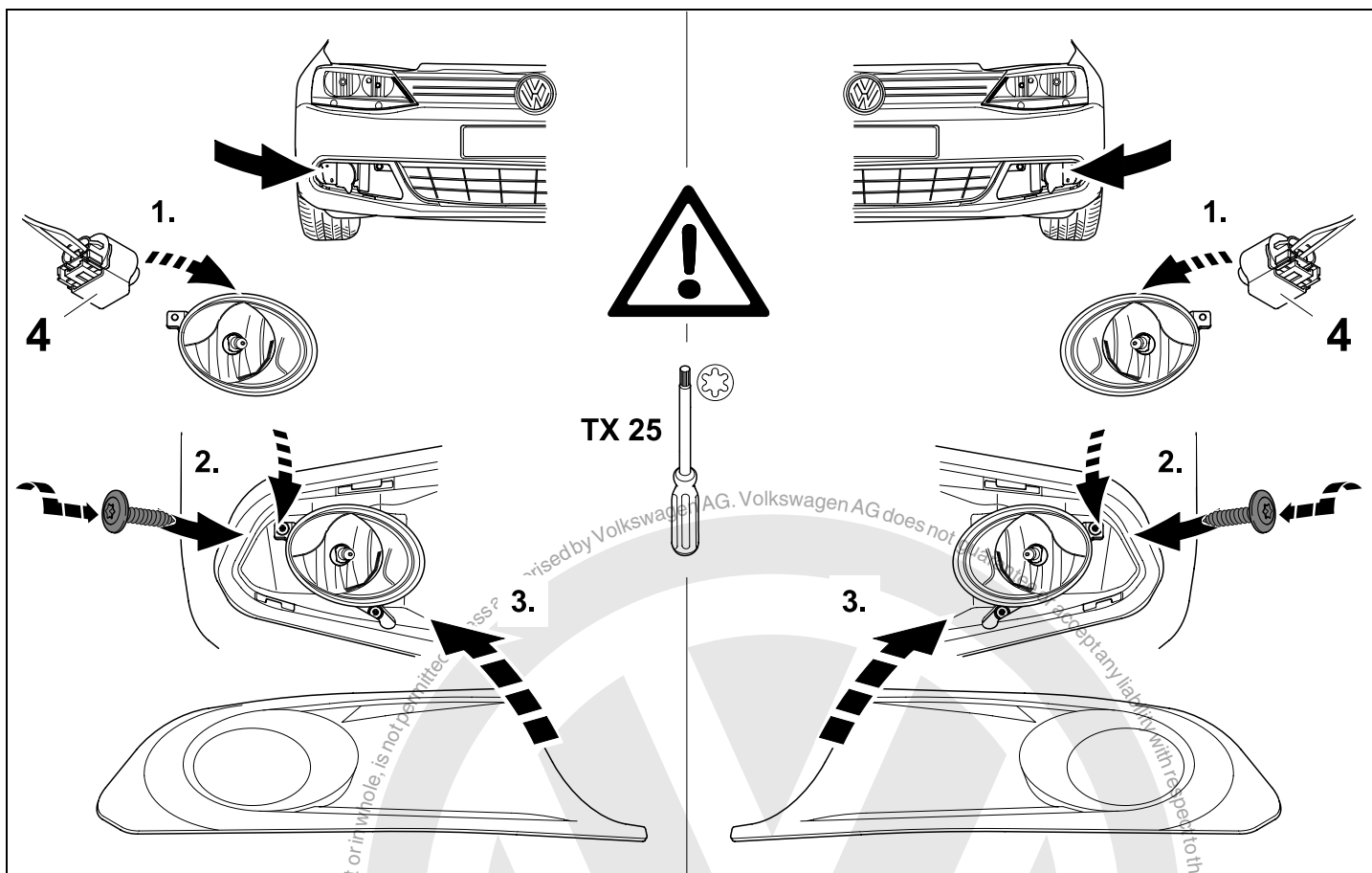

23 Fog lamp installation Beetle

Beetle

Due to higher installation effort, please refer to ELSA for fog lamp installation



NOTE !

- The reassembling of the vehicle should be done in reverse order
- Electric cables should be passed and fixed along existing cables and fixing points. Improper passed and fixed cables can cause short circuits and may lead to fire of the vehicle
- These fitting instructions should be handed over to the vehicle's owner and all subsequent vehicle's owners
- If the radio code is needed, ascertain by using ELSA
- After reconnection of the battery it is possible that the indicator lamp for ESP is active. In this case the steering angle sensor has to be trained. Refere to ELSA for the correct procedure.
- Clear the vehicle's fault memory after completion of work
- After completion of work adjust the fog lights according ELSA and legal regulations

Important information

- The fog lights will be out of function when the left and right high beam filaments are damaged at the same time

24 Check all functions Jetta / Beetle

Switch ignition on and activate fog lights by rotating the light switch knob and pulling it

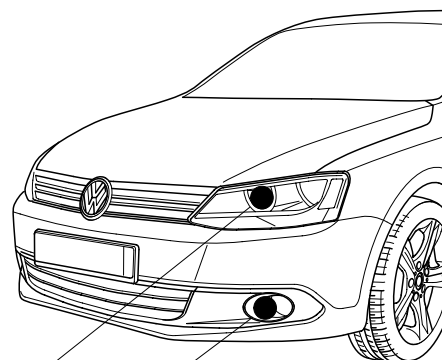
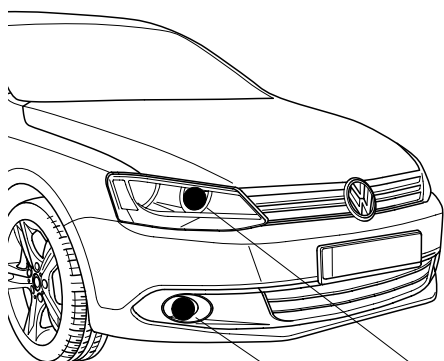

Low Beam on

Fog lights on

High Beam on = Fog lights off

Cautions & Warnings

Please read these WARNINGS and CAUTIONS before proceeding with maintenance and repair work. You must answer that you have read and you understand these WARNINGS and CAUTIONS before you will be allowed to view this information.

- If you lack the skills, tools and equipment, or a suitable workshop for any procedure described in this manual, we suggest you leave such repairs to an authorized Volkswagen retailer or other qualified shop. We especially urge you to consult an authorized Volkswagen retailer before beginning repairs on any vehicle that may still be covered wholly or in part by any of the extensive warranties issued by Volkswagen.
- Disconnect the battery negative terminal (ground strap) whenever you work on the fuel system or the electrical system. Do not smoke or work near heaters or other fire hazards. Keep an approved fire extinguisher handy.
- Volkswagen is constantly improving its vehicles and sometimes these changes, both in parts and specifications, are made applicable to earlier models. Therefore, part numbers listed in this manual are for reference only. Always check with your authorized Volkswagen retailer parts department for the latest information.
- Any time the battery has been disconnected on an automatic transmission vehicle, it will be necessary to reestablish Transmission Control Module (TCM) basic settings using the VAG 1551 Scan Tool (ST).
- Never work under a lifted vehicle unless it is solidly supported on stands designed for the purpose. Do not support a vehicle on cinder blocks, hollow tiles or other props that may crumble under continuous load. Never work under a vehicle that is supported solely by a jack. Never work under the vehicle while the engine is running.
- For vehicles equipped with an anti-theft radio, be sure of the correct radio activation code before disconnecting the battery or removing the radio. If the wrong code is entered when the power is restored, the radio may lock up and become inoperable, even if the correct code is used in a later attempt.
- If you are going to work under a vehicle on the ground, make sure that the ground is level. Block the wheels to keep the vehicle from rolling. Disconnect the battery negative terminal (ground strap) to prevent others from starting the vehicle while you are under it.
- Do not attempt to work on your vehicle if you do not feel well. You increase the danger of injury to yourself and others if you are tired, upset or have taken medicine or any other substances that may impair you or keep you from being fully alert.
- Never run the engine unless the work area is well ventilated. Carbon monoxide (CO) kills.
- Always observe good workshop practices. Wear goggles when you operate machine tools or work with acid. Wear goggles, gloves and other protective clothing whenever the job requires working with harmful substances.
- Tie long hair behind your head. Do not wear a necktie, a scarf, loose clothing, or a necklace when you work near machine tools or running engines. If your hair, clothing, or jewelry were to get caught in the machinery, severe injury could result.
- Do not re-use any fasteners that are worn or deformed in normal use. Some fasteners are designed to be used only once and are unreliable and may fail if used a second time. This includes, but is not limited to, nuts, bolts, washers, circlips and cotter pins. Always follow the recommendations in this manual - replace these fasteners with new parts where indicated, and any other time it is deemed necessary by inspection.

Cautions & Warnings

- Illuminate the work area adequately but safely. Use a portable safety light for working inside or under the vehicle. Make sure the bulb is enclosed by a wire cage. The hot filament of an accidentally broken bulb can ignite spilled fuel or oil.
- Friction materials such as brake pads and clutch discs may contain asbestos fibers. Do not create dust by grinding, sanding, or by cleaning with compressed air. Avoid breathing asbestos fibers and asbestos dust. Breathing asbestos can cause serious diseases such as asbestosis or cancer, and may result in death.
- Finger rings should be removed so that they cannot cause electrical shorts, get caught in running machinery, or be crushed by heavy parts.
- Before starting a job, make certain that you have all the necessary tools and parts on hand. Read all the instructions thoroughly; do not attempt shortcuts. Use tools that are appropriate to the work and use only replacement parts meeting Volkswagen specifications. Makeshift tools, parts and procedures will not make good repairs.
- Catch draining fuel, oil or brake fluid in suitable containers. Do not use empty food or beverage containers that might mislead someone into drinking from them. Store flammable fluids away from fire hazards. Wipe up spills at once, but do not store the oily rags, which can ignite and burn spontaneously.
- Use pneumatic and electric tools only to loosen threaded parts and fasteners. Never use these tools to tighten fasteners, especially on light alloy parts. Always use a torque wrench to tighten fasteners to the tightening torque listed.
- Keep sparks, lighted matches, and open flame away from the top of the battery. If escaping hydrogen gas is ignited, it will ignite gas trapped in the cells and cause the battery to explode.
- Be mindful of the environment and ecology. Before you drain the crankcase, find out the proper way to dispose of the oil. Do not pour oil onto the ground, down a drain, or into a stream, pond, or lake. Consult local ordinances that govern the disposal of wastes.
- The air-conditioning (A/C) system is filled with a chemical refrigerant that is hazardous. The A/C system should be serviced only by trained automotive service technicians using approved refrigerant recovery/recycling equipment, trained in related safety precautions, and familiar with regulations governing the discharging and disposal of automotive chemical refrigerants.
- Before doing any electrical welding on vehicles equipped with anti-lock brakes (ABS), disconnect the battery negative terminal (ground strap) and the ABS control module connector.
- Do not expose any part of the A/C system to high temperatures such as open flame. Excessive heat will increase system pressure and may cause the system to burst.
- When boost-charging the battery, first remove the fuses for the Engine Control Module (ECM), the Transmission Control Module (TCM), the ABS control module, and the trip computer. In cases where one or more of these components is not separately fused, disconnect the control module connector(s).
- Some of the vehicles covered by this manual are equipped with a supplemental restraint system (SRS), that automatically deploys an airbag in the event of a frontal impact. The airbag is operated by an explosive device. Handled improperly or without adequate safeguards, it can be accidentally activated and cause serious personal injury. To guard against personal injury or airbag system failure, only trained Volkswagen Service technicians should test, disassemble or service the airbag system.

Cautions & Warnings

- Do not quick-charge the battery (for boost starting) for longer than one minute, and do not exceed 16.5 volts at the battery with the boosting cables attached. Wait at least one minute before boosting the battery a second time.
- Never use a test light to conduct electrical tests of the airbag system. The system must only be tested by trained Volkswagen Service technicians using the VAG 1551 Scan Tool (ST) or an approved equivalent. The airbag unit must never be electrically tested while it is not installed in the vehicle.
- Some aerosol tire inflators are highly flammable. Be extremely cautious when repairing a tire that may have been inflated using an aerosol tire inflator. Keep sparks, open flame or other sources of ignition away from the tire repair area. Inflate and deflate the tire at least four times before breaking the bead from the rim. Completely remove the tire from the rim before attempting any repair.
- When driving or riding in an airbag-equipped vehicle, never hold test equipment in your hands or lap while the vehicle is in motion. Objects between you and the airbag can increase the risk of injury in an accident.

I have read and I understand these Cautions and Warnings.

